

**FOR SMOOTH DEDUSTING OF MIXING PROCESSES AND
CONVENIENT DUST RECYCLING.**



**Filter materials with
extra long durability**

**Made possible
through outstanding
construction design**

**Easy integration into
existing systems**

The MIXFI is a mixing filter used for direct dedusting of mixed charges.

Areas of Application

- Smooth dust recycling of filter dusts to the mixer
- Direct installation on top of an exhaust air chute or
- Dust collection box design with aspiration port on the side through which the mixing filter can be installed directly next to the mixer and dedust it through a flexible tube.
- Special dedusting system with vacuum flaps respectively leak air at the mixer cleanout.
- Variable 2/2 way solenoid valve and ventilator voltage in AC or DC.
- Clocked relay for cleaning the filter cartridges (optional).

- Filter body made out of steel ST 32-2, lacquered, hammer tone silver gray respectively stainless steel.

Details / Explanation

Finish

Dimensions Mixfi

| Filter area m ² | 10,5 | 15 | 18 | 21 |
|----------------------------|-----------|-----------|-----------|------------|
| a / a+ | 600 / 480 | 800 / 490 | 800 / 460 | 800 / 990 |
| b / b+ | 1390 / 50 | 1390 / 90 | 1590 / 85 | 1790 / 165 |
| c / c+ | 300 / 205 | 400 / 145 | 400 / 115 | 400 / 240 |
| d | 660 | 860 | 860 | 860 |
| e | 330 | 460 | 460 | 460 |
| f | 105 | 166 | 166 | 166 |
| g | 750 | 950 | 950 | 950 |
| h | 3 x 100 | 2 x 215 | 2 x 215 | 2 x 215 |
| Ø l | 295 | 295 | 295 | 295 |
| m | 250 | 400 | 400 | 400 |

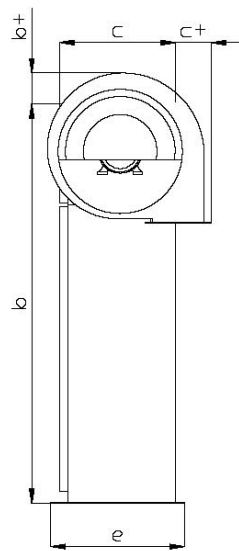

Standard

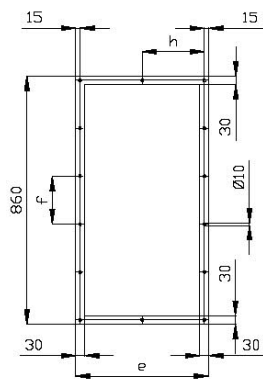
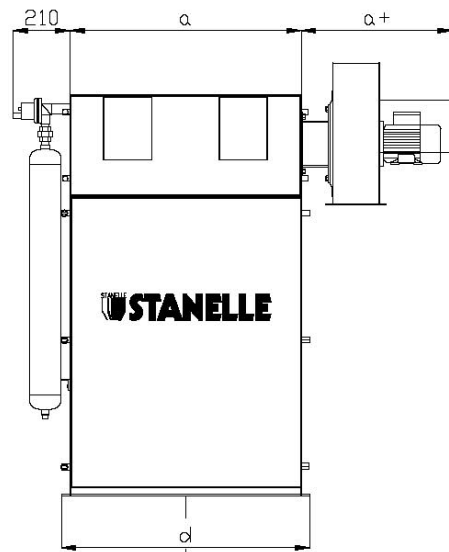

Connection hole pattern

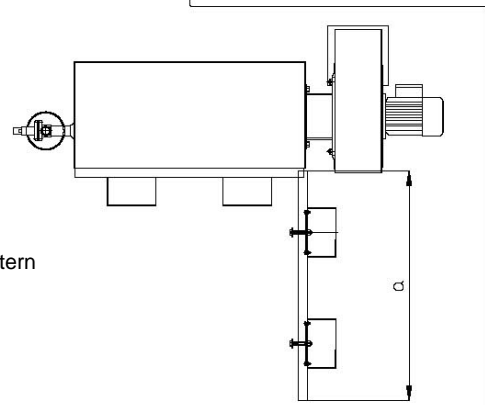

with hose barb

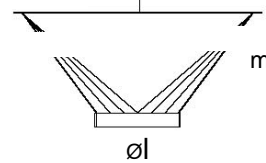
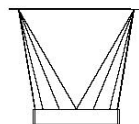

with dust collection box

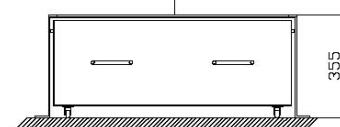
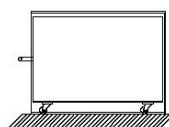

Technical Data Mixfi

| Filter area m ² | 10,5 | 15 | 18 | 21 |
|-----------------------------|---------------|------------|------------|------|
| Mixer size up to | 1.125 ltr. | 2.500 ltr. | 4.500 ltr. | |
| Capacity Nm ³ /h | 500 | 750 | 900 | 1050 |
| Maximum temperature | 120° C | | | |
| Filter cartridges / pcs. | 3 | | | |
| Filter medium | Polyester | | | |
| Solenoid valve / pcs. | 1 | | | |
| Operating pressure | max. 6 bar | | | |
| Air connection / mm | ø 12 | | | |
| Actuation air | 160 Nltr/min. | | | |
| Weight kg | 80 | 110 | 120 | 140 |
| Ventilator output kW | 0,37 | 0,75 | 1,1 | 1,5 |
| Ventilator voltage | 230 / 400 V | | | |

Article Number

| Filter area m ² | 10,5 | 15 | 18 | 21 |
|----------------------------|------------|------------|------------|------------|
| Article number | 722 10 266 | 722 10 269 | 722 10 272 | 722 10 301 |

Extra charges for

| Dust collection box for filter area m ² | 10,5 | 15 | 18 | 21 |
|--|------------|------------|------------|------------|
| Article number | 722 10 105 | 722 10 104 | 722 10 104 | 722 10 104 |

Various voltages and explosion proof versions of ventilator and solenoid valve coils are available!

Notice



Additional sizes and options (e.g. pressure surge protected version) can be tailored to your special application!

Notice



When placing an order please define the materials which are mixed in your silo system (e.g. cement, lime etc...)

Accessories for Mixfi

| Dedusting control for top hat rail installation | Article number |
|--|----------------|
| For dedusting of the mixing filter during the mixer cleanout. Control board for on site installation into the control box. Blow time set up, break time adjustable through potentiometer (2 – 15 s). Voltage 230 V AC | 881 10 062 |
| Alternative: Mounted to the plastic box on the filter and completely wired. Control process see above. Voltage 230 V AC | 881 10 063 |

Additional Accessories for Mixfi

| Adapterflange: To flange on the mixing filter. Hosebarb specification St 37, rust removal SA 1. Grounding and top coat hammer stroke grey. | Mixfi 10,5 | Mixfi 15 / 18 | | Mixfi 21 |
|---|------------|---------------|------------|------------|
| | Ø 300 | Ø 300 | Ø 500 | Ø 500 |
| Article number | 722 10 012 | 722 10 082 | 722 10 139 | 722 10 139 |

| Spiral tube: For connecting the mixer air vent with the adapter flange of the mixing filter. To exhaust the air/dust mixture from the mixer. Per running meter | Mixfi 10,5 | Mixfi 15 / 18 | | Mixfi 21 |
|---|------------|---------------|------------|------------|
| | Ø 300 | Ø 300 | Ø 500 | Ø 500 |
| Article number | 722 10 080 | 722 10 080 | 722 10 074 | 722 10 074 |

| Special tube clamp: For spiral tube | Ø 300 | Ø 500 |
|-------------------------------------|------------|------------|
| Article number | 722 10 103 | 722 10 075 |